

Vertical Impact Crushers VIC

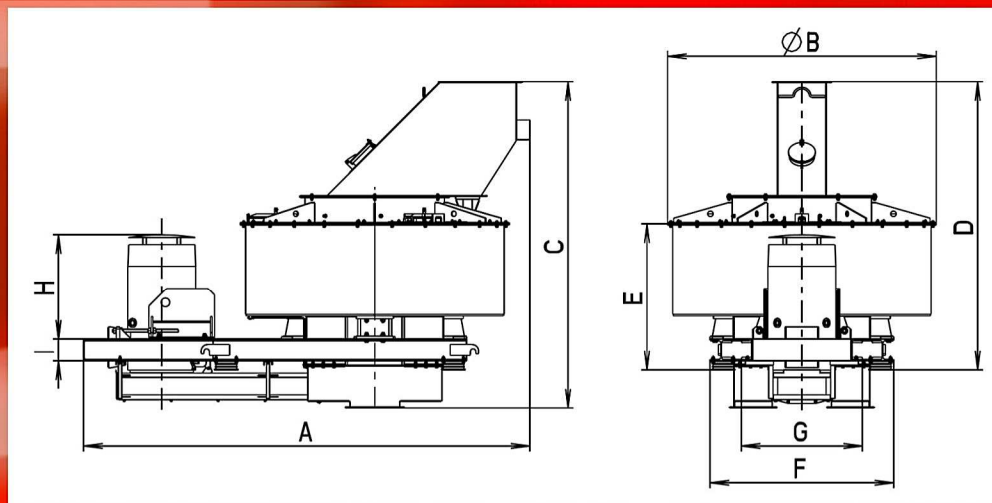



Type mark	A	B	C	D	E	F	G	H	I
VIC 80	3720	2320	2750	2390	1260	1570	1110	960	200
VIC 100	4090	2460	2990	2640	1340	1680	1110	960	200

Vertical Impact Crushers VIC

Impact crushers VIC are characterized by their vertically mounted rotor. These machines are used for production of aggregates with a high content of cubic grains. The VIC crushers are located in a final stages of technological lines, especially in places where the emphasis is on a very high quality shape value of product.

Impact crushers VIC can be used for a wide spectrum of application. They can be utilized for crushing hard and soft materials, but also for abrasive and non-abrasive materials.

Impact Crushers VIC = Many advantages

- increase operational efficiency
- excellent shape value of the product
- easy exchange of crushing elements
- highly wear resistant materials application
- high quality = highly economic operation

Type mark		VIC 80	VIC 100
Capacity	tph	60 - 120	100 - 180
El. power input	kW	90 - 110	132 - 160

